

# Former Shaw's Plaza 360 Daniel Webster Hwy, Merrimack, NH



**AVAILABLE FOR LEASE – 1,500-9,000 SF units, plus 37,000 +/- SF Anchor with NAMING RIGHTS \$10-15 PSF NNN — ANCHOR SPACE NEGOTIABLE**

**Total renovation planned, SECURE SPACE NOW! Restaurant, fitness, hardware, showroom, service & office**

## MERRIMACK'S GROWING DESIRABILITY

- **10-MINUTES FROM EXIT 10!**
- **NEW Merrimack Premium Outlets Mall at Exit 10**
- **Anticipated 5.8 million annual visits to the area**
- **Merrimack Chamber of Commerce Visitor Guide available at local businesses & online promotes traffic**
- **NEW Airport Access road open, linking Manchester Regional Airport/Everett Turnpike**

*The spillover-effect from the millions of anticipated annual Premium Outlets visits is already happening.* Mall visitors are expanding their experience by shopping throughout the town, adding dining, lodging and other area recreation. The expansion will forever position Merrimack as a key retail destination.

Strategically located between Nashua and Manchester at exit 11, a few minutes north on Rt. 3, the Plaza offers an impressive parking field, signalized entrance, highway access, signage/exposure and more.

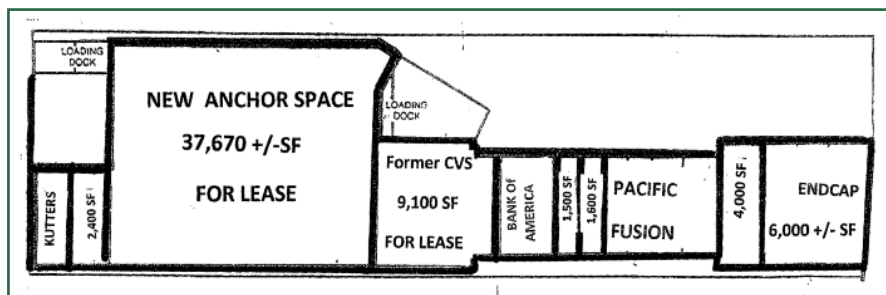

## DEMOGRAPHICS

Radius	Population (2010)	HH Income (2010)
2-mile	9,271	\$94,851
4-mile	38,423	\$94,922
6-mile	91,979	\$97,321

Source: U.S. Census Bureau

Merrimack's average demographics boast strong disposable income with a growing residential base in the surrounding areas.

**OVER 2,200 BUSINESSES** — employing thousands — lie within close proximity to supplement the local population. The roster includes many of the state's largest companies such as:

- Anheuser Busch
- Brookstone
- BAE Systems
- PC Connection
- Fidelity Investments
- Elbit Systems

## FOR MORE INFORMATION CONTACT

**Andrew Levy, CCIM**

**603-493-1007 [M] 603-434-6700 x223 [O]**

**andy@themegcompanies.com**

License: NH 004755



**MEG Asset Management, Inc.**  
25 Orchard View  
Londonderry, NH 03053  
[www.themegcompanies.com](http://www.themegcompanies.com)